

What's new in brightwheel

Brightwheel is always evolving to better serve you

We're committed to making life easier for administrators, staff, and families. That's why we regularly release updates designed to streamline workflows and help you get more out of brightwheel.

In this PDF, you'll find the latest tools and improvements as of January 2026!

Experience Assessments

NEW Family Friendly Reports

Teachers using the Developmental Continuum Framework can now download and share a clear, easy-to-understand report that shows where a child is in their development and what milestones they're working toward next. Share digitally or in person during parent-teacher conferences.

[Learn more in your account](#)

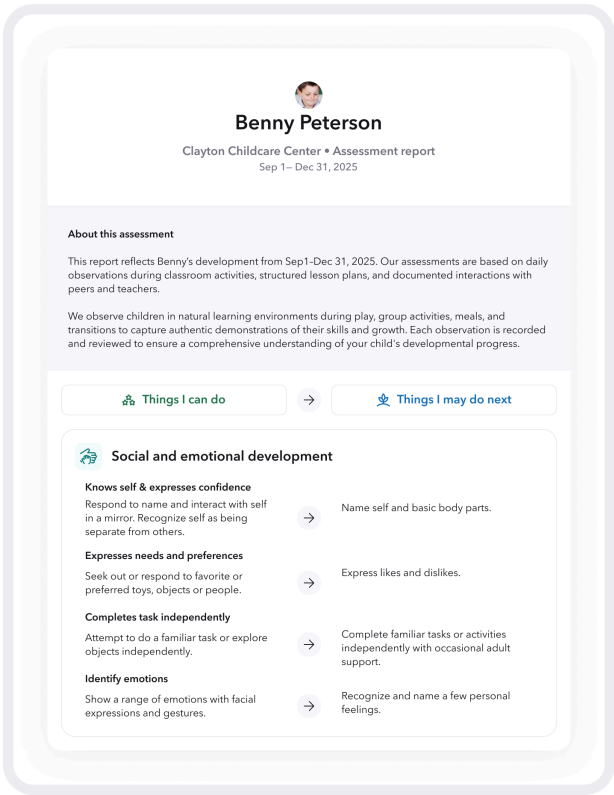

Check-in code Toggle

Easier check-ins for families

Guardians can choose to display their check-in code on the Parent Dashboard when they open the app, making drop-off faster and reducing forgotten codes. This can be customized in their Profile on the mobile app.

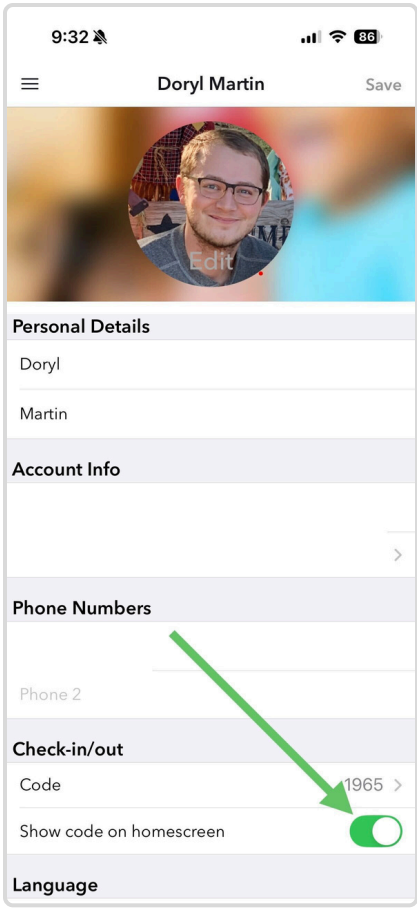

Search for Admins

Find what you need, faster

Quickly search for and navigate to profiles, settings, and features across brightwheel's web application, no more clicking through tabs.

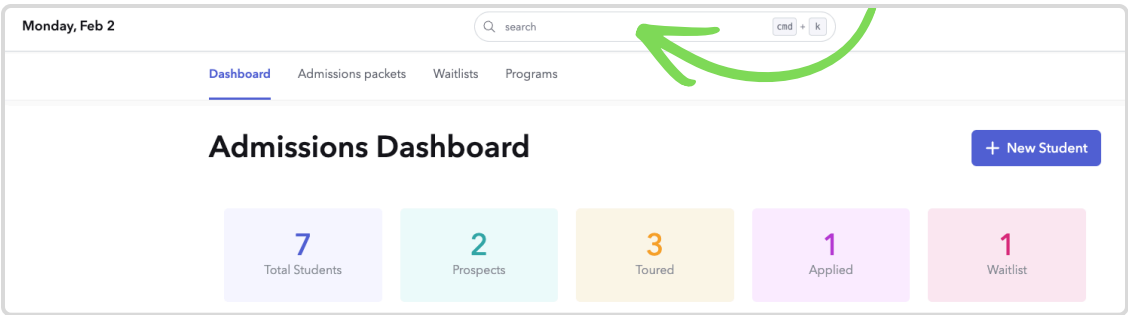

Menus revamp

What’s New

- **Reusable menu templates:** build once, then copy or rotate across weeks
- **Faster menu building:** select items from the food library
- **Food library:** items are pre-added from the USDA Food Buying Guide, with the ability to add more as needed

[Learn more in our Help Center](#)

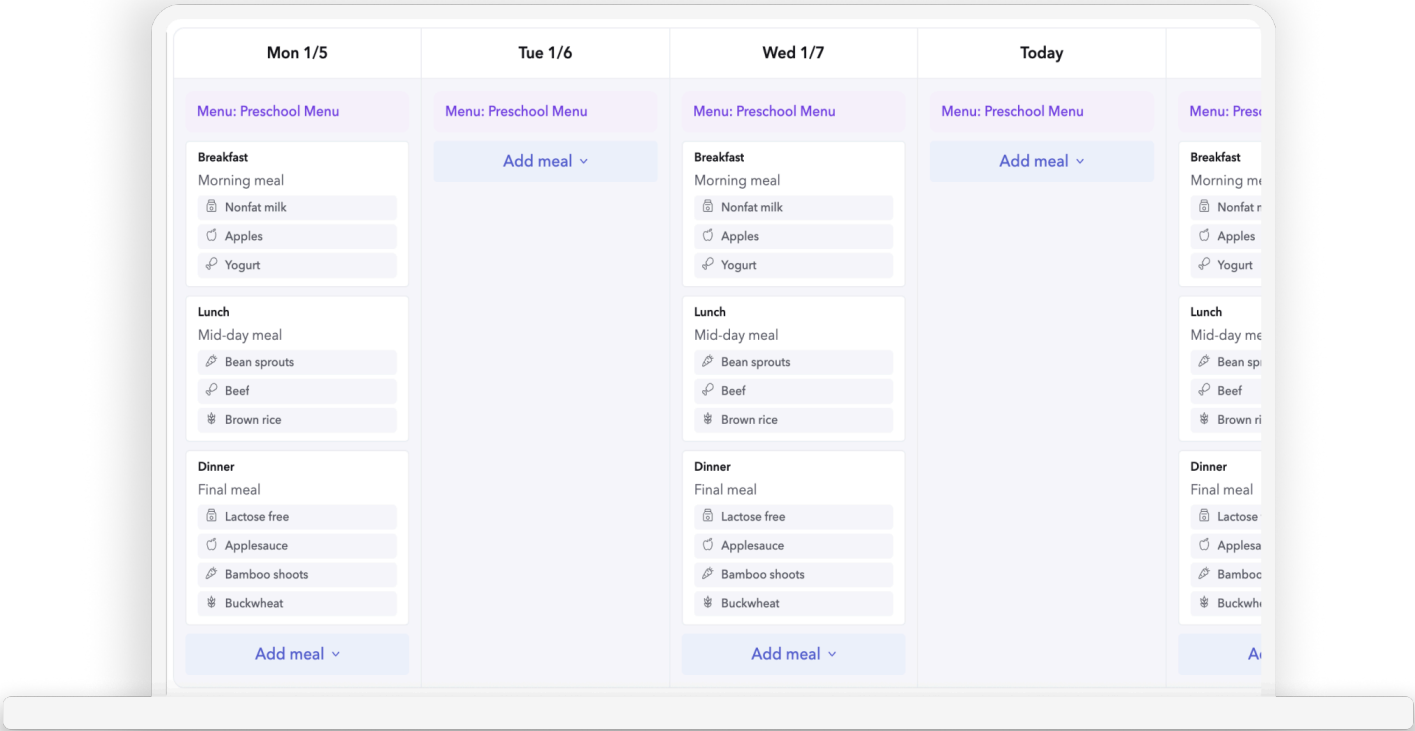

CACFP Guardrails Toggle

Stay CACFP-compliant with built-in checks

When this setting is enabled, brightwheel automatically checks menus and meals against CACFP meal component requirements and alerts you if anything is missing so you can fix issues before they become a problem.

[Learn more in our Help Center](#)

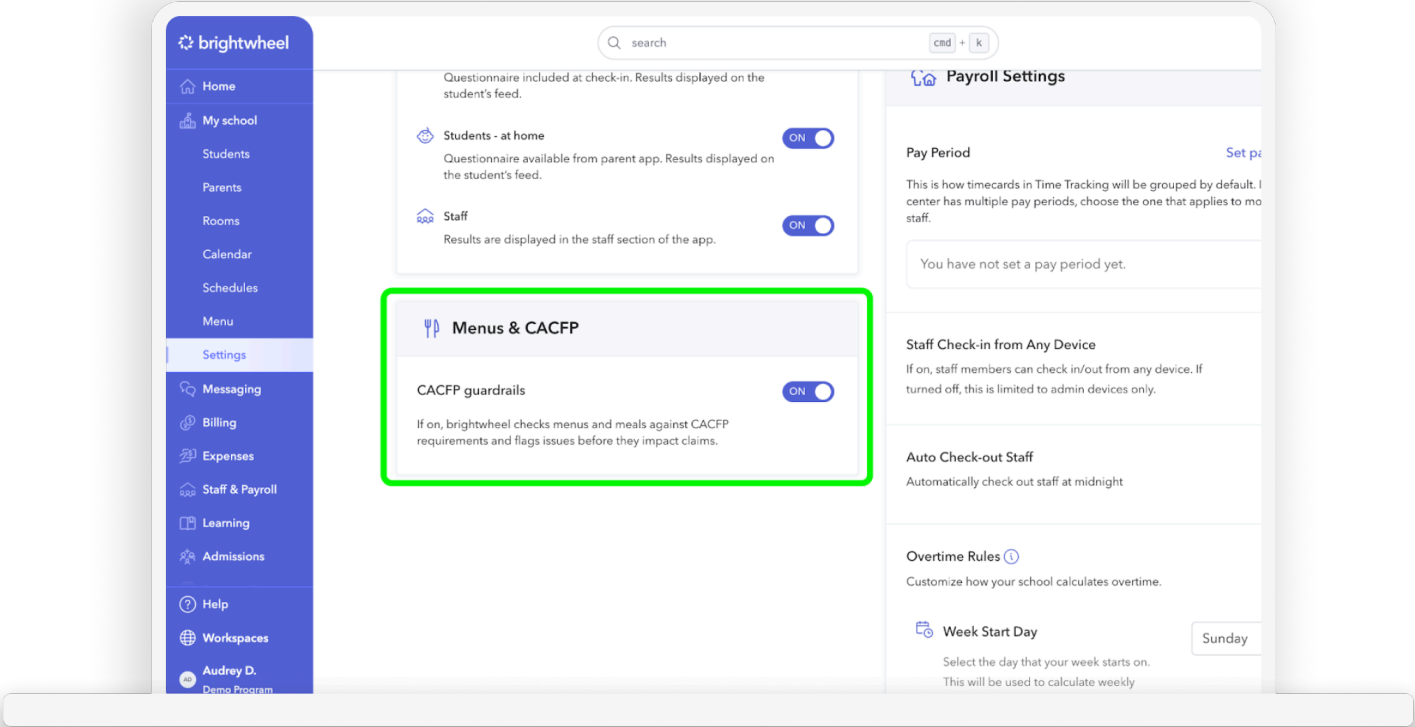

Professional Development Dashboard

Track staff training at a glance

See how many professional development courses staff have completed and how they’re progressing toward their state annual training requirements in brightwheel.

[Learn more in your account](#)

Monday, Feb 2

search

crd + k

Staff

Training

Time tracking

Time off

Payroll

Training

View courses

Add training record

Date range

2/2/2025 - 2/2/2026

Staff

Staff	Completed hours	Completed CEUs	Completed courses
Andy Cohen	15.0	0.5	2
Ben Robinson	2.0	0.2	1
Daisy Kelliher	10.0	1.0	1
Hannah Ferrier	10.0	1.0	1

brightwheel

Home

My School

Messaging4

Admissions

Billing

Staff \$ Payroll

Learning

Documents

Reporting

Free Month!

Help

Jenn JonesABC Center

Staff

Training

Time tracking

Time off

Payroll

+ Training record

Brittney Flynn

Signed up

Label *

Complete

In progress

Not started

Courses

19

Completed CEUs

1.9

Completed hours

17

Certifications

17

Course	Hours	Status	
Classroom Management and ...	1	Completed	View certificate
Sensory Play and Sensory Fun.....	1	Completed	View certificate
Creating Welcoming Environments	1	Completed	View certificate
Continuity of Care for Infants...	1	Completed	View certificate
Super Staff Supervision	1	Not started	Remind